

Door Preparation

- 1. Fold template over edge of door and mark holes.
- 2. Drill a 2 1/8" hole through the face of the door.
- 3. Drill two 3/8" thru bolt holes through face of door.(only if the thru bolts are being used).
- 3. Drill a 1" hole in edge of door.
- 4. Cut 5/32" notches on 2 1/8" hole on both sides of door. (Very important if not using thru bolts.)
- 5. Mortise latch unit front 2 1/4" x 1 1/8" x 1/8"

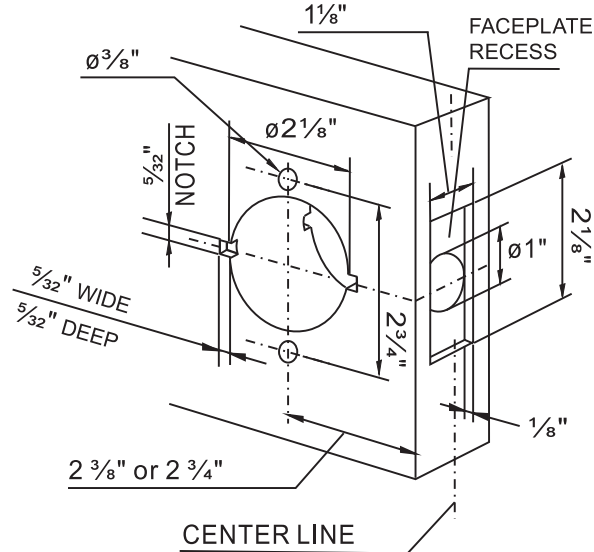

1 DISASSEMBLE INSIDE LEVER

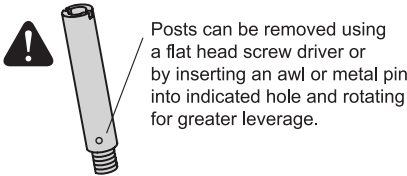
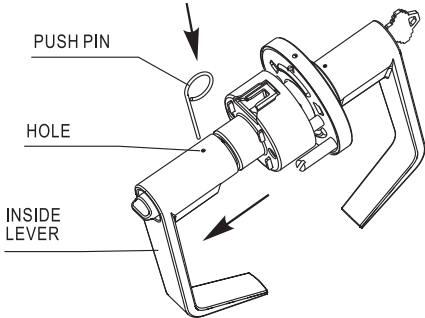

1A: Insert push pin into hole to depress catch and remove the lever.

2 INSTALL LEVERSET TO DOOR

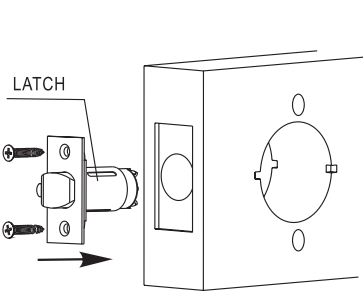

2A: Insert latchbolt and secure with combination screws.

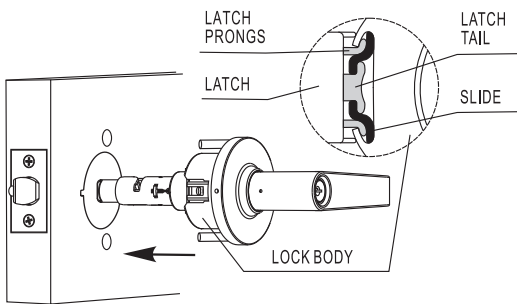

2B: Place lock body into position. Make sure that latch prongs engage chassis in housing, and slide engages latch tail.

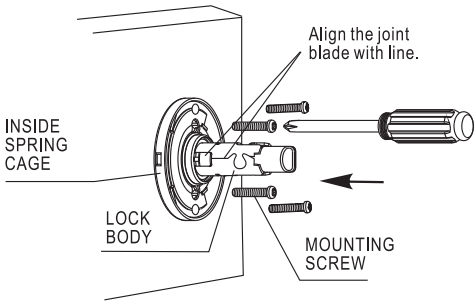

2C: Install inside spring cage, screws should be hand tightened all the way down with a screwdriver.

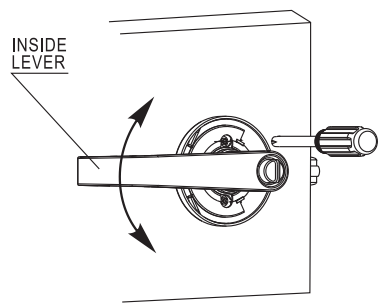
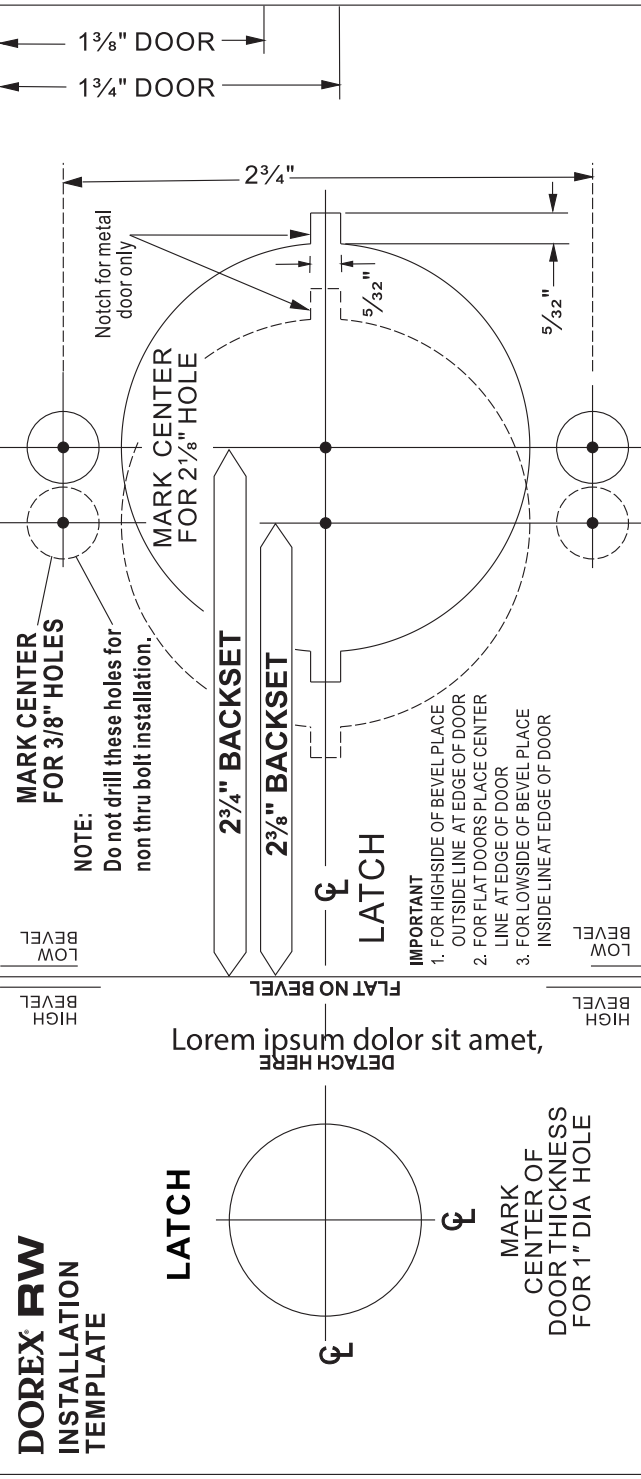

2D: Slide inside lever onto spindle and check to see if the rotation is smooth.

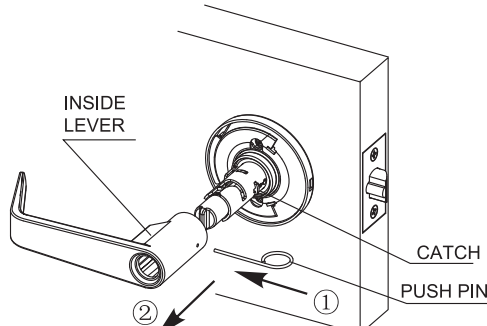

2E: Remove inside lever using push pin.

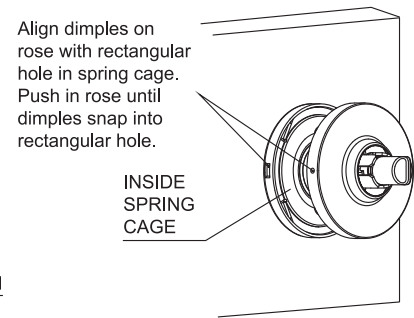

2F: Install inside rose and make sure inside rose and inside spring cage are tightened.

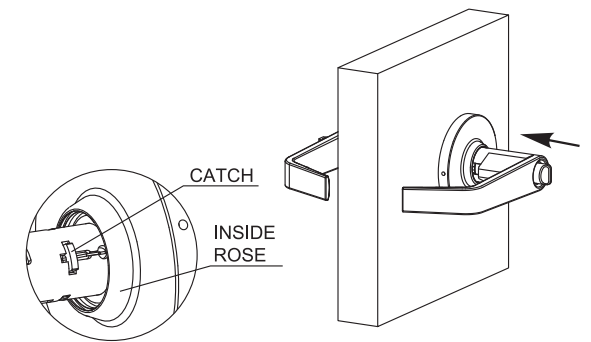

2G: Slide lever onto spindle. Push lever completely into place. (Pull on lever to make sure that catch is fully engaged).

3 INSTALL STRIKE

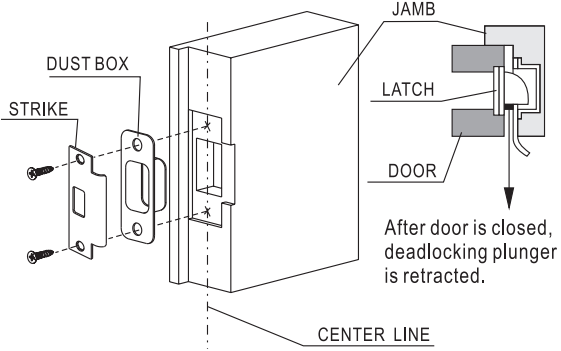

4 INSTRUCTIONS FOR REMOVING AN INSTALLED LOCK FROM THE DOOR

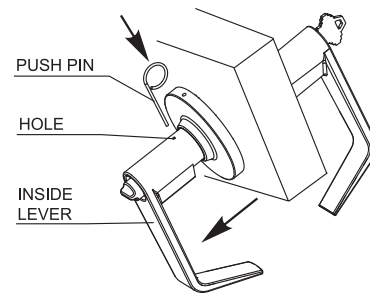

4A: Insert push pin into hole to depress catch and remove the lever.

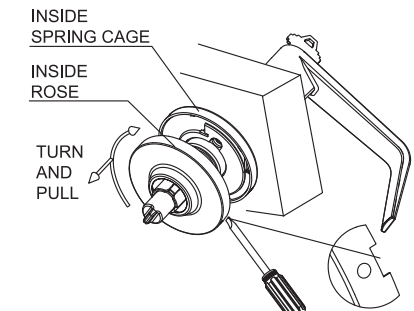

4B: Remove inside rose by turning and pulling off.

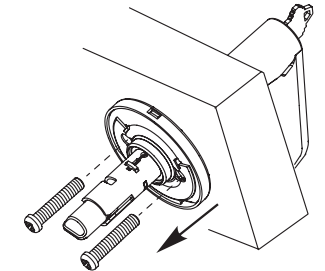

4C: Remove mounting screw with screwdriver and inside spring cage.

5 INSTRUCTIONS FOR ADJUSTING LOCK TO FIT DOOR THICKNESS

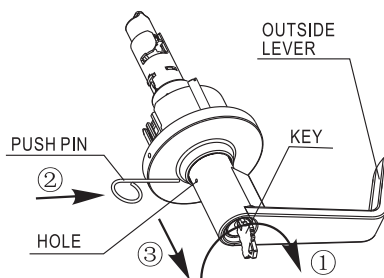

5A: Turn key 75° clockwise, insert push pin into hole in outside lever to depress catch. Remove the outside lever.

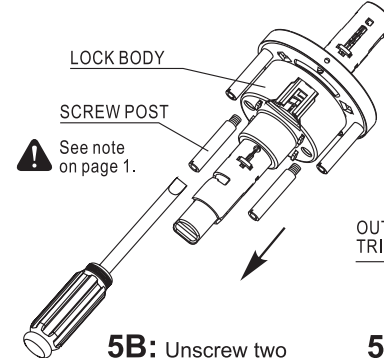

5B: Unscrew two posts in lock body by flat screwdriver.

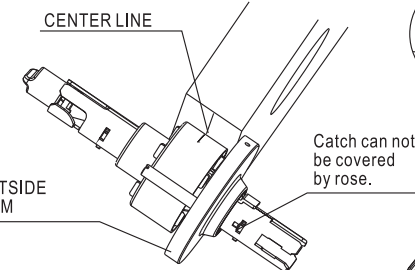

5C: Adjust outside trim according to the door thickness, make sure the lock body at both sides is symmetrical.

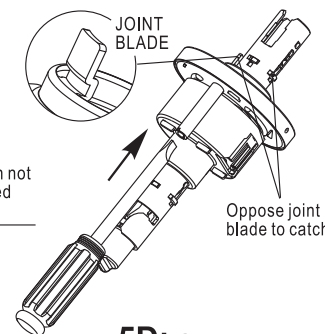

5D: Screw to posts back in so they hold the outside rose tightly.

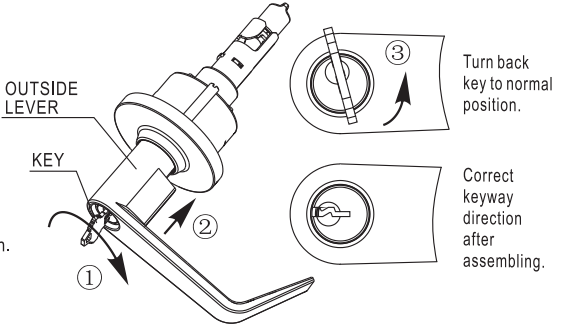

5E: Turn key approximately 80° clockwise and push the lever all the way onto the spindle and then turn key back to normal position.

