

DOOR PULLS

GENERAL HARDWARE

DOREX 18R-E SERIES

STRAIGHT ROUND PULLS, MITERED, 1¼" DIAMETER

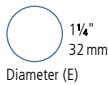

Single pulls are thru-bolt mounted with round end-caps

APPLICATIONS

- For wood or metal doors 1⅜ – 2¼" (35–57 mm) thick
- For glass doors ⅝ – ½" (8–13 mm) thick

FEATURES

- 304 Stainless steel
- Available in paired or single pulls
- Single pulls are thru-bolt mounted with round end-caps
- All necessary mounting hardware included
- Packaged in an eco-friendly, fully recyclable, box



SELECTION GUIDE

SERIES	LENGTH†	DIAMETER	TYPE	FINISH	DESCRIPTION
18R	24	E	B	630	Straight Round Pull, 1¼" (32 mm) Mitered, 24" Center-to-Center, Back-to-Back, Satin Stainless Steel
	24, 36	E 1-1/4 (32)	B Back-to-Back	630 Satin Stainless Steel	
	48, 60, 72		S Single	19 Matte black	

IN (MM), (†) CENTER-TO-CENTER.

NOT ALL COMBINATIONS OF STANDARD LENGTHS, TYPES & FINISHES ARE STOCKED. PLEASE REFER TO PRICE LIST OR CONTACT CANAROPA SALES AND SERVICE FOR DETAILS.

DIMENSIONS

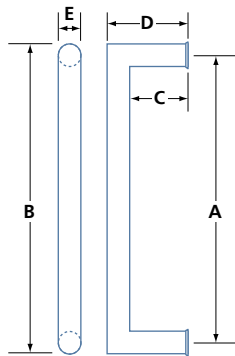

MODEL	A CENTER-TO-CENTER	B TOTAL LENGTH	C POSTS	D PROJECTION	E DIAMETER
18R24	24 (610)	25¼ (641)	27/16 (62)	31/16 (94)	1¼ (32)
18R36	36 (915)	37¼ (946)	27/16 (62)	31/16 (94)	1¼ (32)
18R48	48 (1220)	49¼ (1251)	27/16 (62)	31/16 (94)	1¼ (32)
18R60	60 (1524)	61¼ (1556)	27/16 (62)	31/16 (94)	1¼ (32)
18R72	72 (1829)	73¼ (1861)	27/16 (62)	31/16 (94)	1¼ (32)

IN (MM)