

## 1 Mark Door

- 1 Place template on door and mark center for 2 1/8" hole at desired backset.
- 2 Template should be placed on high edge of beveled door edge.

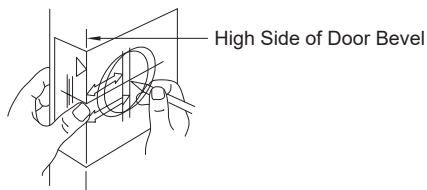

## 2 Bore Two Holes

- 1 Bore a 2 1/8" diameter hole. To avoid splintering a wood door, bore the hole from both sides of the door.
- 2 Drill a 1" diameter hole from the edge of door that intersects the 2 1/8" hole.
- 3 Using the gate latch bolt faceplate as a guide, mortise the edge of door to recess the faceplate 5/32" deep.

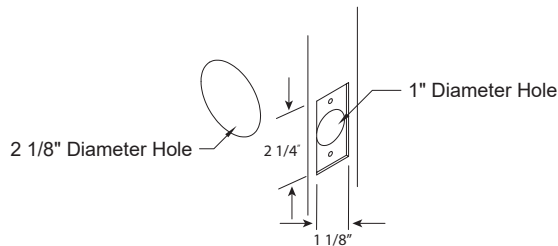

## 3 Prepare Door Jamb

In alignment with the center of the gate latch bolt, mortise the door jamb to fit the strike box and strike plate 3/16" deep with security plate or 1/8" deep with strike only.

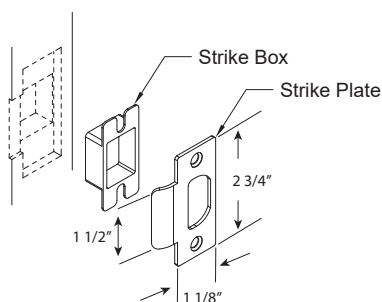

## 4 Install Strike Plate

- 1 Place support plate with screw holes toward doorstop.
- 2 Mark and drill two 3/16" holes for 3" woodscrews.
- 3 Install security place, strike box and strike plate in the order shown.
- 4 Test lock with key and turn knob. Bolt must travel and project fully into strike preparation without binding.

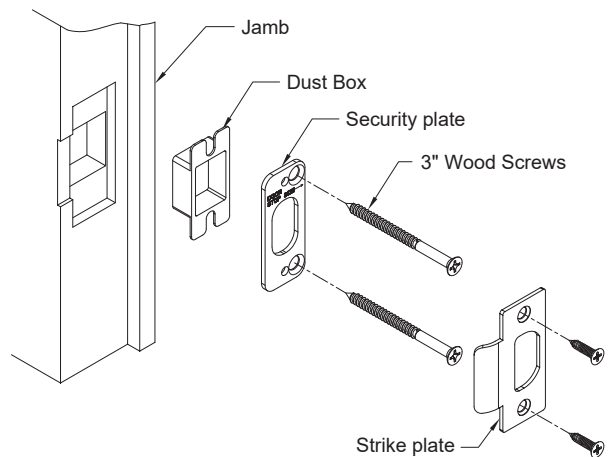

## 5 Install Gate Latch Bolt Assembly

- 1 Insert the gate latch bolt with slotted spindle hole at the bottom of the assembly.
- 2 Secure the gate latch bolt to the door with screws.

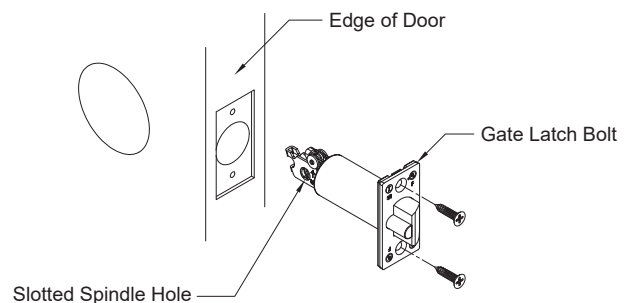

## 6 Install Cylinder(s)

### For Single Cylinder Gate Latch Bolt:

- 1 Extend the bolt with a screwdriver.
- 2 Install the cylinder and trim assembly with the spindle in the vertical position.

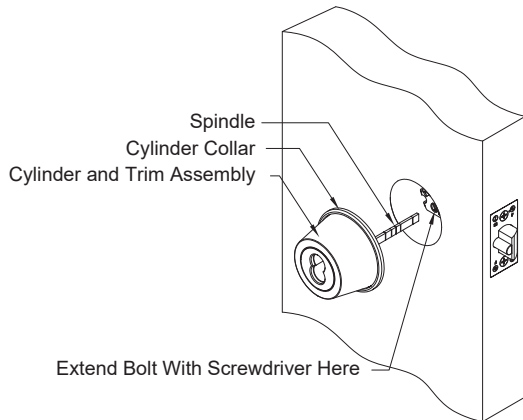

### For Double Cylinder Gate Latch Bolt:

- 1 Extend the bolt with a screwdriver.
- 2 Install each cylinder with its trim assembly.
- 3 Insert long mounting screws and tighten.
- 4 Check to make sure the gate latch bolt operates properly.
- 5 Insert the face.

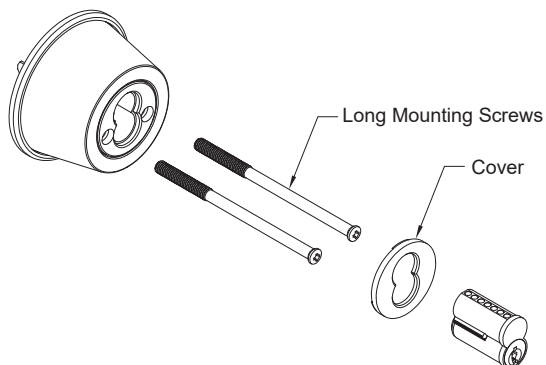
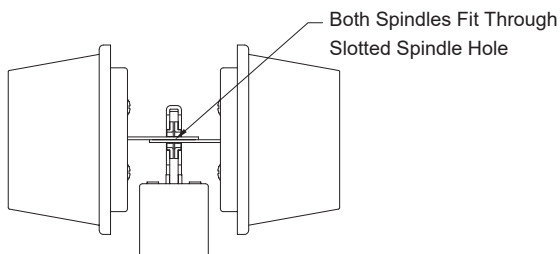

- Note**
- 1 Mount cylinders on the door so that the mounting screws enter from the inside of the door.
  - 2 Both spindles must fit through the spindle hole in the gate latch bolt assembly.

## 7 Attach Inside Trim

- 1 Break the spindle at the appropriate notch to suit the installation.
- 2 Slide the turn knob assembly over the spindle and secure it and the cylinder to the door with mounting screws supplied.
- 3 Check to make sure that the gate latch bolt operates properly.

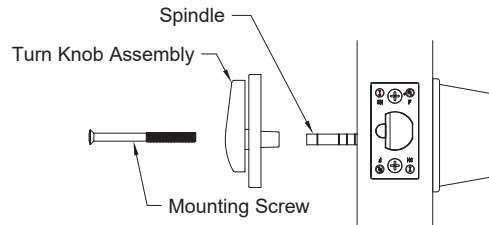

## 8 Install Core(s)

- 1 Put the control key into the core and turn the key 15 degrees clockwise.
- 2 Adjust the throw pins if needed, then put the core into the cylinder with the control key.
- 3 Turn the key 15 degrees counterclockwise and remove the key.

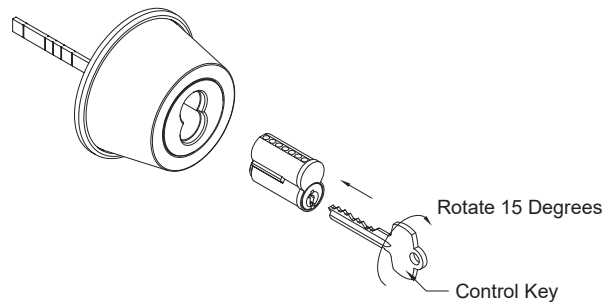

**Caution:** Double cylinder locks are operated by key only and may hinder emergency exit. Check for applicable fire codes and/or life safety codes before installing double cylinder gate latch bolt.