

DOREX® T2

Functions | 10, 40, 53,  
70, 80

*This document describes a recommended installation based on common product and industry standards. It is the customer's responsibility to determine the validity or suitability of these recommendations for a particular purpose or installation.*

**FOR USE ON DOORS 1-3/8"~2" (35mm-51mm) THICK**  
**TOOLS REQUIRED FOR NEW INSTALLATION:**  
1x Phillips head screwdriver  
1x 2-1/8" (54mm) hole saw  
1x 1" (25.4mm) drill bit  
1x 5/16" (8mm) drill bit  
1x chisel  
**TOOLS REQUIRED FOR REPLACEMENT:**  
1x Phillips head screwdriver

ENTRY (53)  
MODEL SHOWN

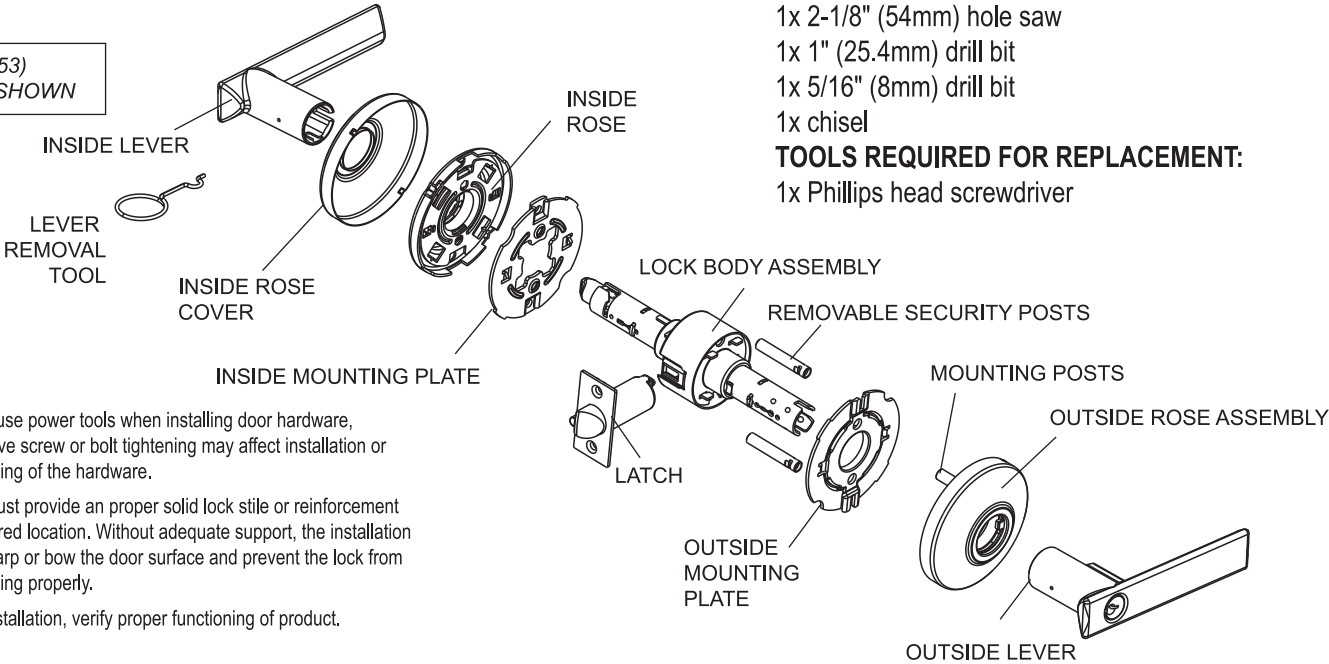

- ⚠ Do not use power tools when installing door hardware, excessive screw or bolt tightening may affect installation or functioning of the hardware.
- Door must provide an proper solid lock stile or reinforcement at required location. Without adequate support, the installation may warp or bow the door surface and prevent the lock from functioning properly.
- After installation, verify proper functioning of product.

**FOR NEW INSTALLATIONS FOLLOW ALL STEPS AS INDICATED.**  
**FOR REPLACEMENTS FOLLOW STEPS 3C, 4C, 5, 6, 7, 8, AND 9**  
**AFTER REMOVAL OF OLD LOCK AND LATCH.**  
**DOOR PREPARATION DOCUMENTS ARE AVAILABLE.**

⚠ Document provided as-is, manufacturer reserves the right to make technical changes without prior notice.

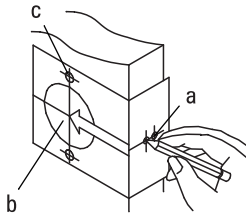
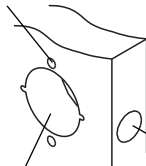
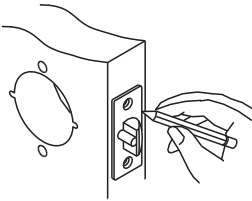
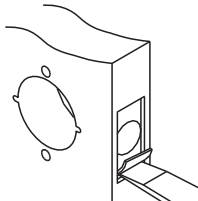
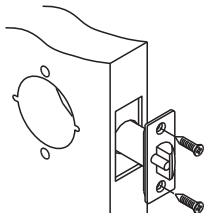
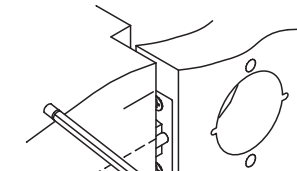
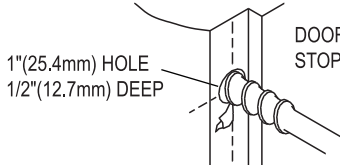
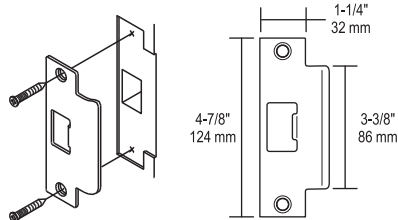
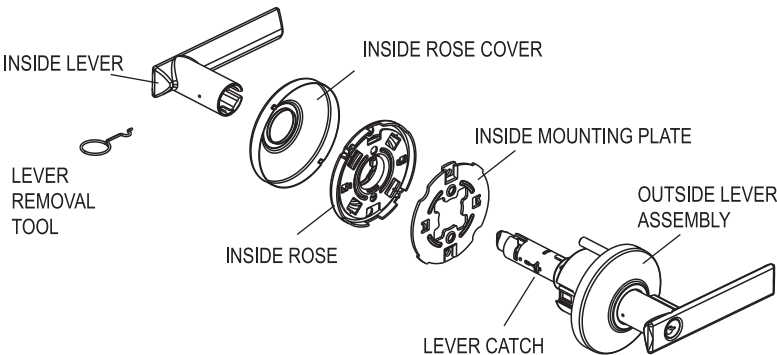
<h3>1. MARK DOOR</h3> <div><p>a. Start 38" (965mm) from floor and mark center of door edge.</p><p>b. Select required backset 2-3/8" (60mm) or 2-3/4" (70mm) and mark hole center on door face.</p><p>c. Mark two holes for screw posts.</p><p><b>NOTE: BACKSET ON DOOR FACE MUST BE SAME AS BACKSET OF YOUR LOCK.</b></p></div>		<h3>1. DRILL HOLES</h3> <div><p>5/16"(8mm) HOLE FOR REMOVABLE SECURITY POST</p><p>Drill holes as marked.</p><p><b>NOTE: DRILL 2-1/8" (54mm) HOLE FROM BOTH SIDES TO AVOID SPLITTING WOOD.</b></p><p>2-1/8"(54mm) HOLE FOR LOCKSET</p><p>1" OR 31/32" (24.6mm OR 25.4mm) HOLE FOR LATCH</p></div>	
<h3>3. INSTALL LATCH</h3>			
<div><p>1-1/8" 29 mm</p><p>2-1/4" 57 mm</p><p>a. Insert latch in hole and keep it parallel to door face. Mark outline and remove latch.</p></div>	<div><p>b. Chisel 5/32" (4mm) deep or until faceplate flush with door edge.</p></div>	<div><p>c. Insert latch and tighten screws.</p><p><b>NOTE: LATCHBOLT BEVEL MUST FACE TOWARDS CLOSING DIRECTION.</b></p></div>	
<h3>4. INSTALL STRIKE</h3>			
<div><p>CENTER LINE</p><p>a. Close door to mark horizontal center line of strike.</p></div>	<div><p>1"(25.4mm) HOLE 1/2"(12.7mm) DEEP</p><p>DOOR STOP</p><p>b. Measure one half of door thickness from the door stop to mark the vertical center line of the strike. Drill a 1" (25.4mm) hole, 1/2" (12.7mm) deep at intersection of horizontal and vertical center lines.</p></div>	<div><p>1-1/4" 32 mm</p><p>4-7/8" 124 mm</p><p>3-3/8" 86 mm</p><p>c. Using the strike as a template. Cut out jamb 3/32" (2.4mm) deep or until strike flush with jamb. Tighten screws securely.</p></div>	
<h3>5. REMOVE INSIDE TRIM</h3>			
<p>Use the lever removal tool to depress the lever catch visible though the hole of inside lever shank and slide off the inside lever, rose, rose cover and mounting plate.</p> <div><p>INSIDE LEVER</p><p>LEVER REMOVAL TOOL</p><p>INSIDE ROSE COVER</p><p>INSIDE ROSE</p><p>INSIDE MOUNTING PLATE</p><p>OUTSIDE LEVER ASSEMBLY</p><p>LEVER CATCH</p></div>			

REV 2023-10-24

6. INSTALL REMOVABLE SECURITY POSTS (THRU-BOLT)

- a. Remove the outside mounting plate from outside rose assembly as shown. Refer the Exterior Lever Removal and Reinstallation instructions.
- b. Create some clearance between outside mounting plate and insert the removable thru-bolts (security posts) into the cavities of outside mounting plate.
- c. Continue with the rest of the instructions.

**!** Removing the security posts will compromise the security strength and rigidity of the lockset.

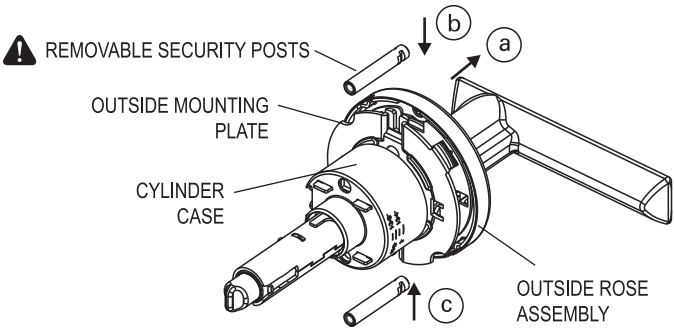

7. ADJUST FOR DOOR THICKNESS

- a. Remove the outside mounting plate from outside rose assembly as shown. Refer the Exterior Lever Removal and Reinstallation instructions.
- b. Insert the lever removal tool into the tool hole as shown on the right.
- c. Rotate outside mounting plate to the required door thickness by using the lever removal tool.
- d. Reassemble exterior assembly.

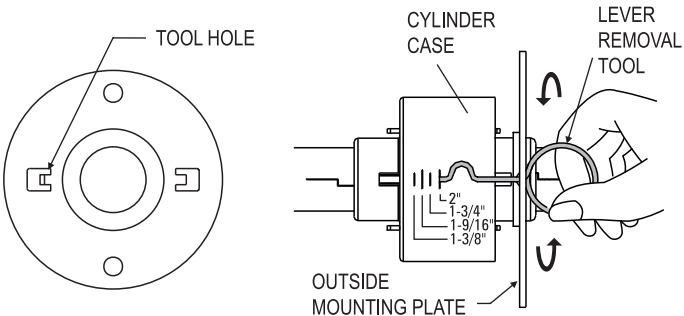

8. REASSEMBLE EXTERIOR ASSEMBLY AND INSTALL

Reassemble the exterior trim (lever, rose, and case). Aligning to the lever notch.



The tab of the rose assembly is positioned on the opposite side of the lever catch, and align to the notch of the lever hole.

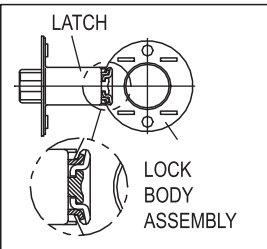

Repeat Step #6 to install the removable security posts. Install outside lever assembly on the door. Make sure tail of the latch engages with retractor correctly as illustrated on the left.

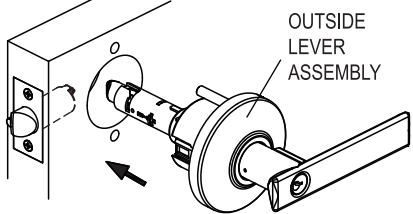

9. INSTALL INSIDE MOUNTING PLATE AND ROSE COVER

- a. Place the mounting plate on to the interior door surface, aligning with mounting screw holes. Turn up the outside lever slightly and tighten screws securely.

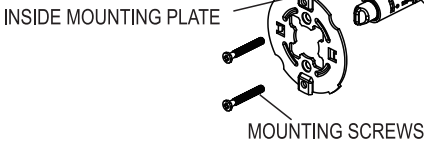

10. INSTALL INSIDE ROSE AND LEVER

- a. Press the rose cover onto the rose. Be sure to press rose cover completely onto the rose.

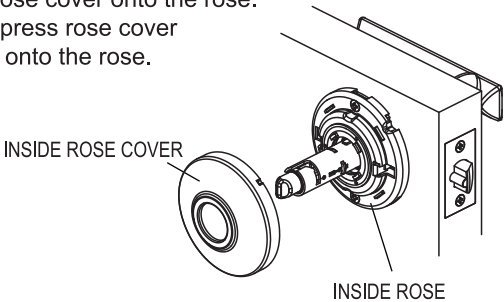

- b. Place the inside rose on to the mounting plate and tighten securely to the security posts with screws.

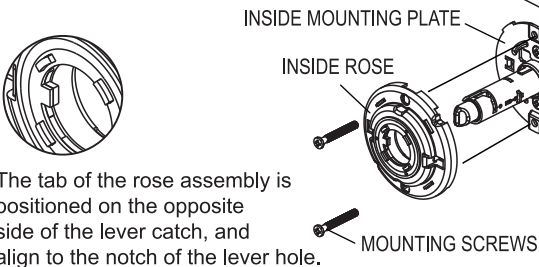

The tab of the rose assembly is positioned on the opposite side of the lever catch, and align to the notch of the lever hole.

If the security posts are not being used, secure the inside rose to the mounting plate using the shorter included screws.

- b. Use the removal catch tool to press down on the catch in the hole and push inside lever all the way in until clicks into the catch hole.

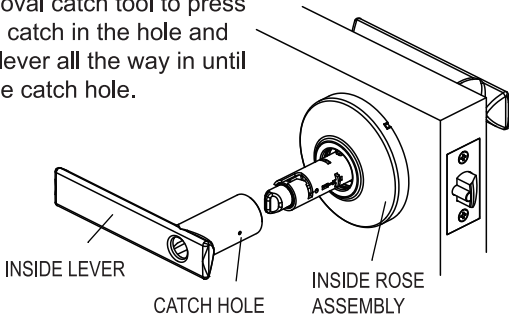

DOREX® T2

INSTALLATION TEMPLATE

For solid doors or hollow doors with proper reinforcement at required location(s).

Drill 25.4mm (1") hole at center of door edge.

51 45 40 35  
2" 1 3/4" 1 1/16" 1 3/8"

**!** Do not use template if not to scale. To verify, confirm dimensions.  
**Door preparation documents available.** Verify preparation with physical hardware before starting any mass preparation, manufacturing or installation work.

FOLD HERE ON DOOR EDGE

2 3/8" (60mm) BACKSET

2 3/4" (70mm) BACKSET

5/16" (8mm) X2 HOLE

MARK CENTER OF 2 1/8" (54mm) HOLE ON DOOR FACE