

# DOREX® DX1 TP

# Installation Instructions

Pull Handle Trim For Exit Device

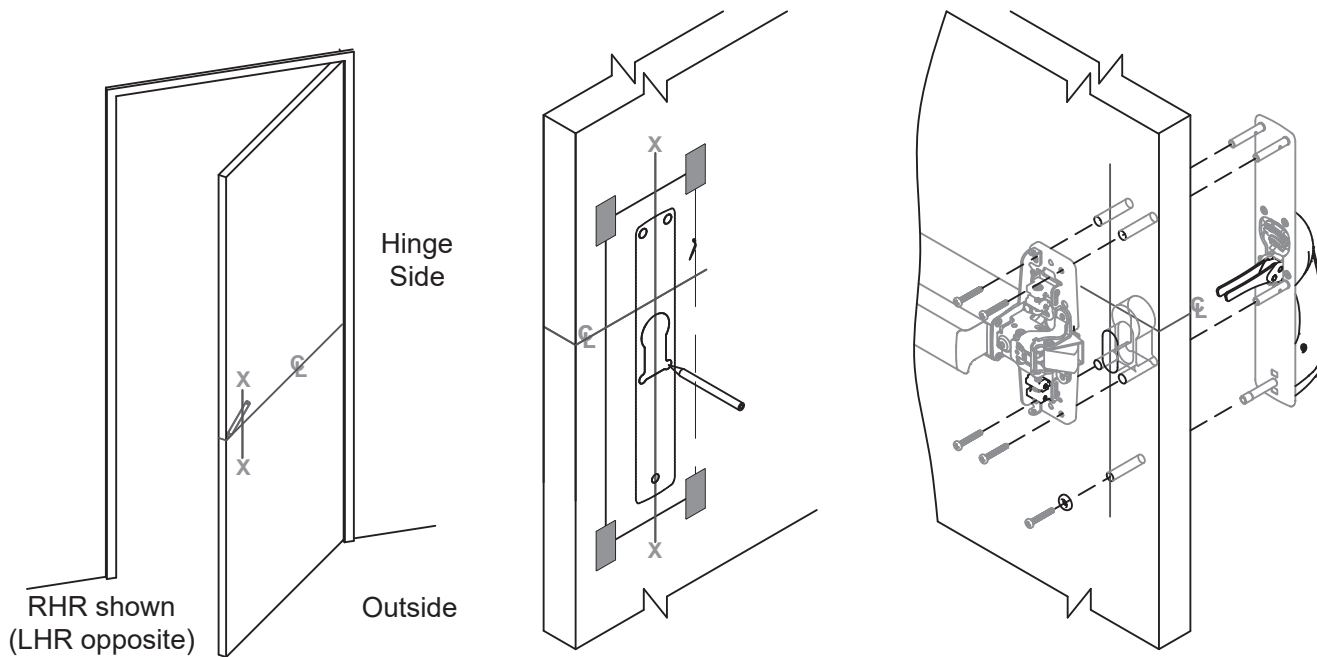

1. Prepare door for exit device. See exit device instructions for holes, backset (line X-X), and center lines.
2. Transfer line X-X from inside (exit device) side of door to outside (trim side) of door. Use extra care if edge of door is beveled. Be sure line X-X is parallel to edge of door.

3. Locate X-X line and prepare required holes with template.
4. Determine trim function and assemble trim. (see "CYLINDER INSTALLATION")

**NOTE:** See "APPLICATION CHART" on back page for different trim functions.

The following step is only applicable for Rim and Vertical Rod Devices.

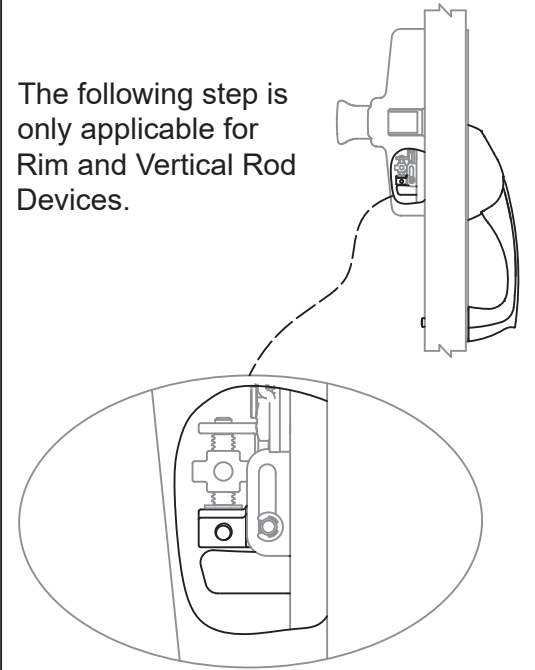

**NOTE:** Check that the Trim's Actuating arm engages the Exit Device correctly.

## CYLINDER INSTALLATION

### Cylinder Cam's Functions

For Lock or unlock Function

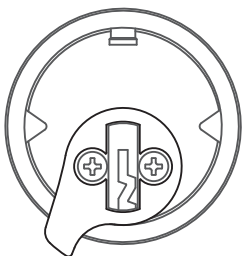

1. Switch between Locked and unlocked state using key, handle retracts latchbolt.

For Night Latch Function



2. Always locked.  
\* Key can unlock the lock, but once removed, the lock will return to its locked position.

### Cylinder Cam Placement for Lock or Unlock / Night Latch Installation

STD Cylinder

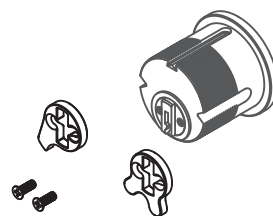

1. Remove screws, switch cam's direction and fasten screws back in place.  
\* Standard Applications Length : 1-1/8"

I/C Core

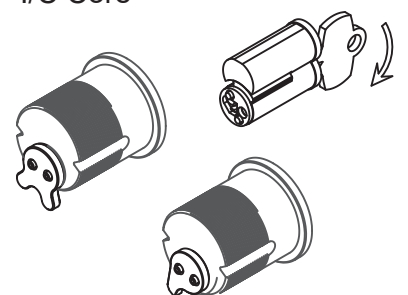

2. Adjust cam into position and insert I/C Core.  
I/C Core Applications Length : 1-3/8"

## LOCK OR UNLOCK / NIGHT LATCH FUNCTION INSTALLATION

1. Use key to rotate cam upwards before installing Cylinder

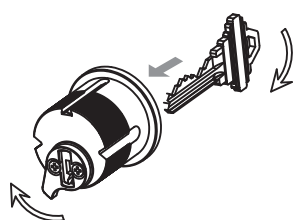

Lock/Unlock Function

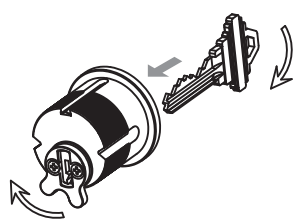

Night Latch Function

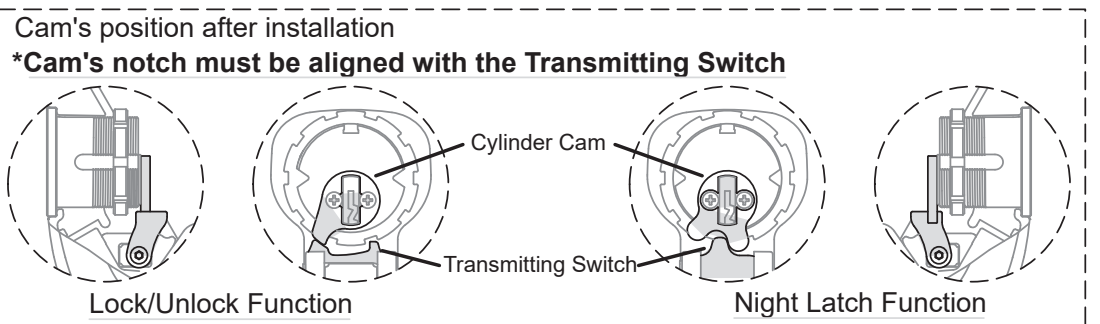

Cam's position after installation

\*Cam's notch must be aligned with the Transmitting Switch

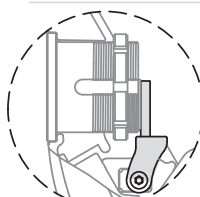

Lock/Unlock Function

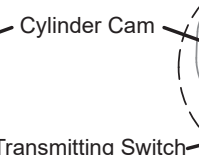
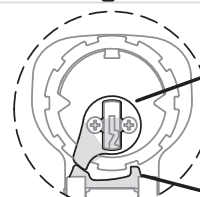

Night Latch Function

2. Insert Cylinder and screw in Cylinder Lock Nut until Cam is free to rotate.

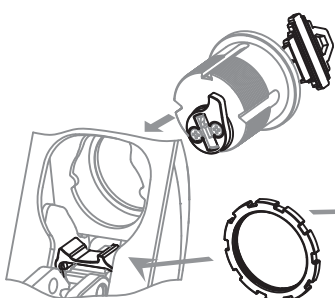

Lock/Unlock Function

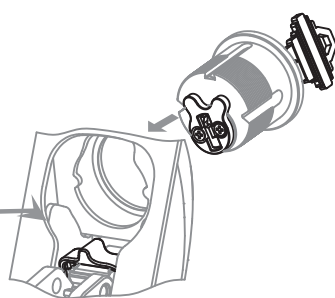

Night Latch Function

3. Use key to rotate Cam to the position where it can drive the transmitting switch.  
(Refer to illustration according to respective function)

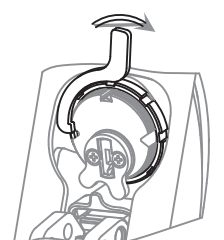
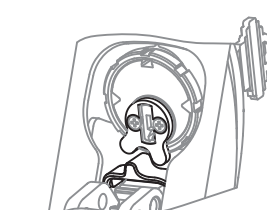
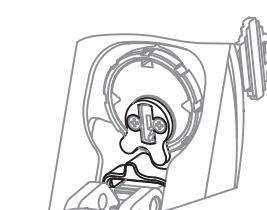
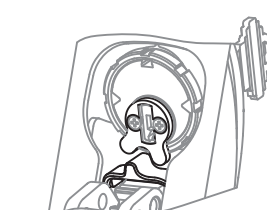

4. Fasten Cylinder Lock nut completely

5. After checking that the function is operating properly, tighten with wrench.

**NOTE:** The illustrations for steps 3,4,5 correspond to Night Latch Function; Lock or Unlock Function follows the same installation procedure

## INSTALLATION FOR MORTISE LOCK

1. Roller installation for RHR and LHR.

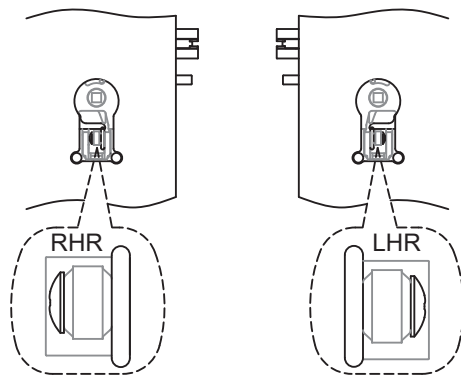

2. Insert Fixing Pin into Roller and fix with Screw.

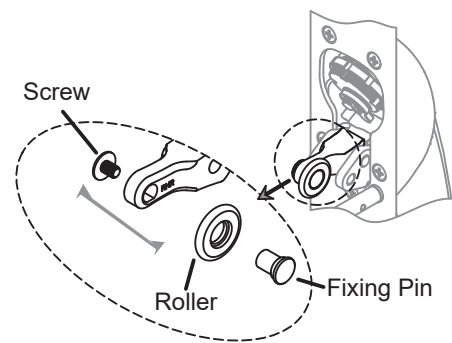

3. Install Retaining Ring on the outer side of the Mortise Case and tighten.

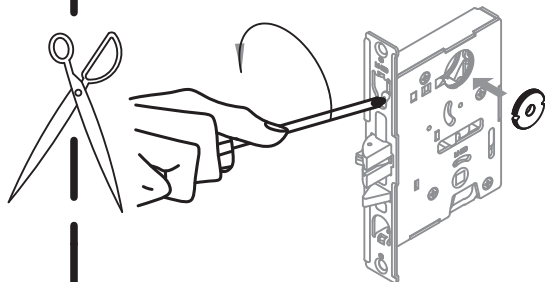

NOTE: The retaining ring must be installed on outer side of the door.

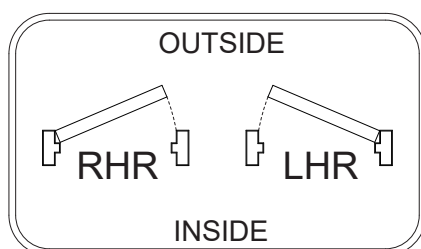

4. Place Trim onto door; check that the Pin and the Retaining rings are aligned correctly and the roller is installed accordingly.

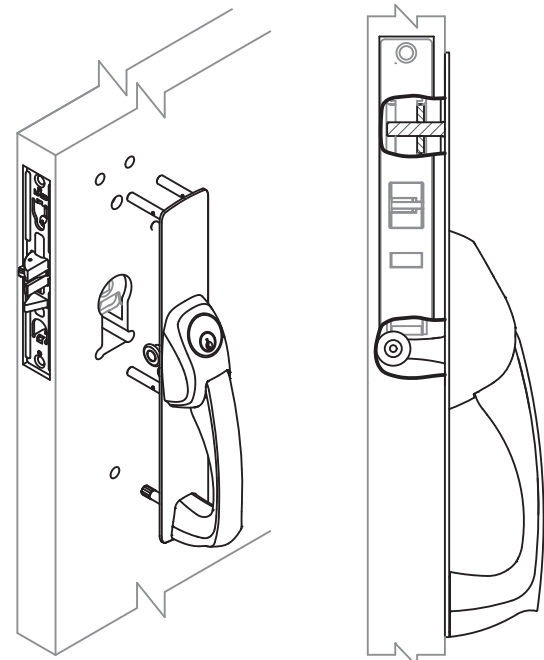

NOTE: If roller is installed incorrectly, the latch will not retract fully.

### FOR DOOR PREPARATION REFERENCE ONLY

- Please use supplied Template for field installations.
- Use Door Preparation documents for door or frame workshop preparation. Consult door preparation for details.
- We recommend samples be used to verify preparation before door or frame manufacturing.
- NOT RESPONSIBLE for any physical or property damage due to incorrect / improper preparation or installation.

## DOOR PREPARATION

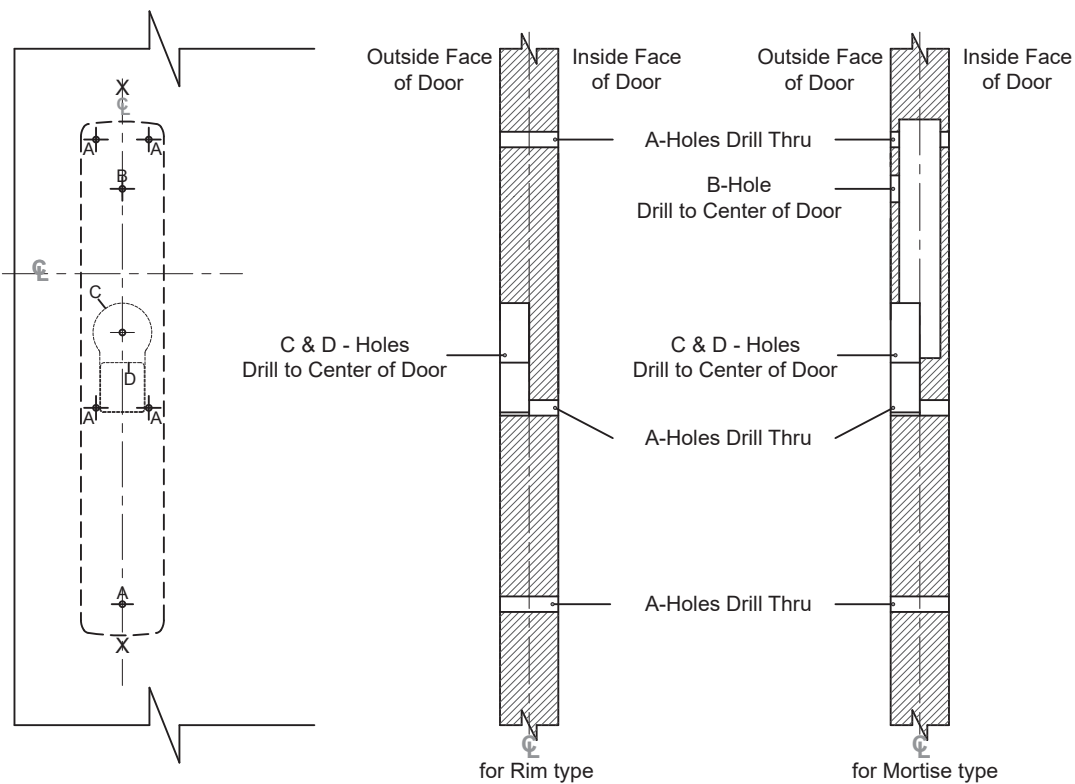

for Rim type

for Mortise type

### APPLICATION

DEVICE TYPE	ALL TYPE	RIM AND VERTICAL		MORTISE LOCK	
CUT OUT ILLUSTRATION					
DX1	TPR02	TPR08/TPR09	TPR14	TPM08/TPM09	TPM14
FUNCTION	02	08/09	14	08/09	14
PREPARATION	A	A+C	A+D	A+B+C	A+B+D

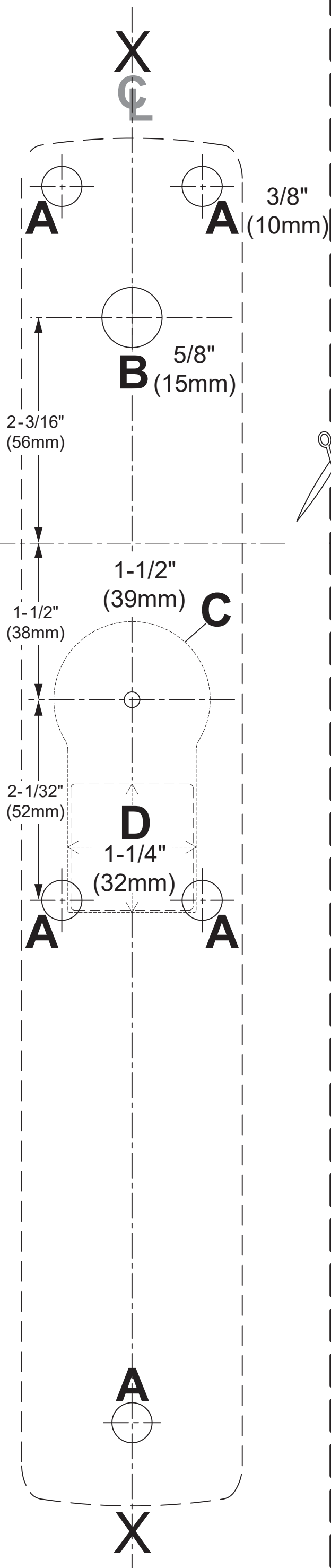

Do not use template if not to scale. To verify, confirm dimensions. Verify template version before use. We recommend samples be used to verify preparation before door / frame manufacturing.